

**REAL-EL**

**OPERATION MANUAL**



**PORTABLE  
RADIO RECEIVER  
X-545**

## ***Congratulations on your purchase of the REAL-EL products!***

### **COPYRIGHT**

© 2022. ENEL GROUP OU.

This Manual and information contained in are copyrighted. All rights reserved.

### **TRADEMARKS**

All trademarks are the property of their legal holders.

## **CONTENTS**

<b>1. BUYER RECOMMENDATIONS .....</b>	<b>1</b>
<b>2. PACKAGE CONTENTS .....</b>	<b>1</b>
<b>3. SAFETY PRECAUTIONS .....</b>	<b>2</b>
<b>4. TECHNICAL DESCRIPTION .....</b>	<b>2</b>
<b>5. CONNECTION AND OPERATION .....</b>	<b>3</b>
<b>6. TECHNICAL SPECIFICATIONS .....</b>	<b>4</b>

### **1. BUYER RECOMMENDATIONS**

- Unpack the device carefully. Make sure there are no accessories left in the box. Check up the device for damage; if the product was damaged during transportation, address the firm, which carried out the delivery; if the product functions incorrectly, address the dealer at once.
- Check up the package contents and availability of the warranty card. Make sure the warranty card has a shop stamp, a legible signature or the seller's stamp and purchase date, and the goods number corresponds to that in the warranty card. Remember: in case of warranty card loss or discrepancy of numbers you forfeit the right for warranty repairs.
- Do not switch on the speaker system immediately after you bring it into a room from environment with negative temperature! After unpacking, the speaker system should be kept in conditions of room temperature for at least 4 hours.
- Before installing and using the speaker system, read this Manual carefully and keep it for future reference.

### **2. PACKAGE CONTENTS**

Portable radio receiver — 1 pc  
 USB to Micro USB power cable — 1 pc  
 User manual — 1 pc  
 Warranty card — 1 pc

**3. SAFETY PRECAUTIONS**

- Do not open the device and do not perform repairs by yourself. Service and repairs should be performed only by qualified specialists at authorized service centers. The list of authorized service centers is on [www.real-el.com](http://www.real-el.com)
- Make sure that foreign objects do not get inside the holes of the device.
- Protect the device from high humidity, water and dust.
- Protect the device from heating: do not place it closer than 1 m from a heat source. Do not expose it to direct sunlight.
- Do not use any chemical agents for cleaning. Clean it with dry soft cloth only.
- In case of device does not work properly. Please contact place of purchase or service center.

**Special features**

- FM, AM, SW radio
- USB flash and microSD memory cards
- Telescopic rotary antenna
- Built-in battery

**4. TECHNICAL DESCRIPTION**

**Control panel**

- ① Previous track (in Player mode);  
Navigation on the track (long pressing)
- ② Next track (in Player mode);  
Navigation on the track (long pressing)
- ③ MODE: switch mode button: BT/USB/microSD (short pressing);  
The previous folder when pressed and held in USB/microSD mode
- ④ Play/Pause (in Player mode);  
The following folder when pressed and held in USB/microSD mode;  
Disconnecting from the sound source (long pressing in Bluetooth mode)

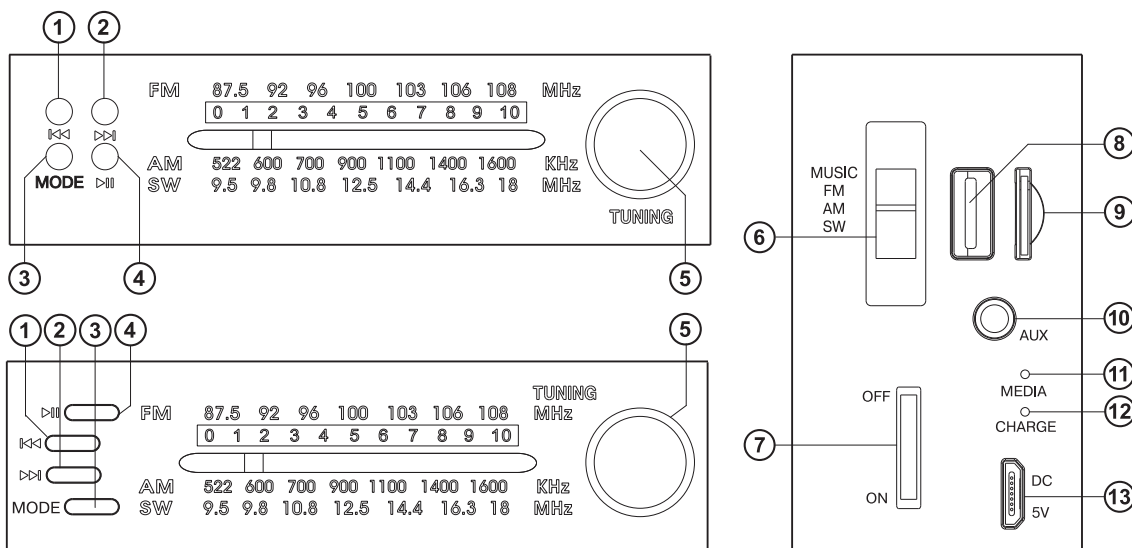

- ⑤ Station tuning knob
- ⑥ Mode selector knob: BT/MP3/FM/AM/SW
- ⑦ ON/OFF knob and volume control
- ⑧ USB flash connector
- ⑨ Micro SD card slot
- ⑩ AUX: 3.5 mm mini-jack for audio signal connecting (phone, MP3 player, etc.)
- ⑪ Player indicator
- ⑫ Battery charge process indicator
- ⑬ DC 5V: micro USB jack for charger connecting radio to laptop/PC USB port

## 5. CONNECTION AND OPERATION

### Charging the battery

- Before operation, fully recharge the battery. The charger is not included. Charge this device with a DC 5V universal charger with output current 2 A.

- Insert the charging cable into the charger connector, connect the other end to the charger, the charging indicator will be activated. The red charging indicators will light up until in full charge.

*It is not recommended to leave the device for a long time connected to the charger after it is fully charged.*

*Do not charge the speaker at low ambient temperatures. The minimum charge temperature is at least 10 °C.*

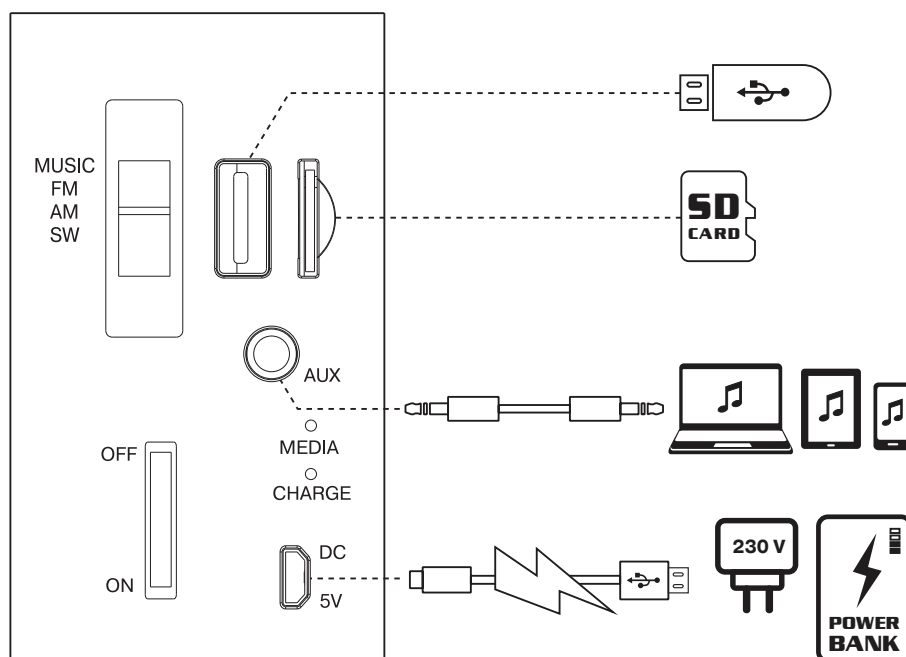

**6. SPECIFICATION**

Parameter	Value
Output power (RMS)	3 W
Frequency range	100-12 000 Hz
Frequency range FM	87.5-108 MHz
Frequency range AM	522-1620 KHz
Frequency range SW	9.5-18 MHz
Dimension of the speaker drivers	Ø 90 mm
Connection types	USB / Micro SD / Aux
Power supply	Micro USB / 5 V DC, 2 A
Battery	Lithium-ion 1200 mAh, @ 3.7 V
Case material	ABS plastic
Dimensions of the product	230 × 147 × 110 mm
Weight	0.84 kg

**Notes:**

- *Technical specifications given in this table are supplemental information and cannot give occasion to claims.*
- *Technical specifications and package contents are subject to change without notice due to the improvement of REAL-EL production.*



Manufacturer: ENEL GROUP OU, Harju maakond, Rae vald, Jüri alevik, Aruküla tee 55a, 75301, Estonia.  
® Registered Trademark of ENEL GROUP OU. Estonia.